

# Ovens for Nonlinear Crystals

## TEMPERATURE CONTROLLER TK2 WITH OVEN KK1



TK2 and KK1 is high temperature set (up to 200 °C) consisting of thermocontroller TK2 and crystal oven KK1. TK2 has two independent outputs and can control two KK1-30 ovens simultaneously. Controller is equipped by LAN and USB computer control interfaces.



Adapter H1 for KK1 mounting on tilt stage

The nonlinear crystal is mounted into adapter before insertion into oven KK1. Such design facilitates handling and replacement of the crystal. The nonlinear crystal can be sealed with fused silica windows in order to provide extra protection. The standard adapters are 30 and 50 mm length with apertures of 3×3, 4×4, 5×5, 6×6 mm ... 12×12 mm size. Oven is delivered with one, customer's specific size of adapter. Adapters for different sizes can be ordered separately.

Separately you can purchase adapter for KK1 mounting on tilt stage.

### SPECIFICATIONS

Model	TK2 + KK1-30	TK2 + KK1-50
Quantity of ovens possible to connect to one controller TK2	2	1
Temperature tuning range	RT-200 °C	
Maximum crystals dimensions	12×12×30 mm	12×12×50 mm
Temperature tuning step	0.05 °C	
Accuracy	± 0.5 °C	
Long-term stability	± 0.05 °C	
Control interfaces	LAN, USB	
Mains	90 – 264 V, 47 – 63 Hz	
Power consumption	< 50 W	
Oven dimensions, Dia×D	Ø52×52 mm	Ø52×72 mm

Specifications are subject to changes without advance notice.

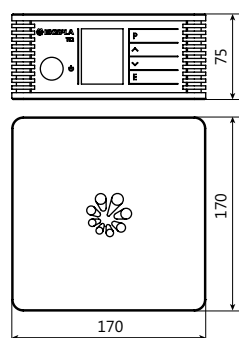

Temperature controller TK2 outline drawing

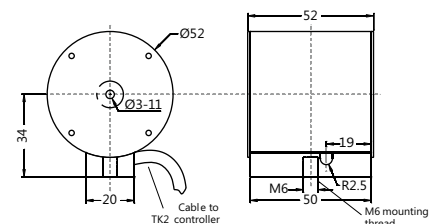

Oven KK1 outline drawing